

DH362NRK Safety Switch



<b>8.1 Safety Switches</b>	
Product Overview . . . . .	2
General Duty . . . . .	24
Heavy-Duty . . . . .	29
Six-Pole Switches . . . . .	42
Double-Throw Switches . . . . .	44
EnviroLine—Stainless Steel Switch . . . . .	52
EnviroLine—Upper and Lower Window Switches . . . . .	55
EnviroLine—Receptacle Switches . . . . .	58
EnviroLine—Non-Metallic Halyester Switch . . . . .	60
EnviroLine—Non-Metallic KRYDON Switch . . . . .	62
NEMA 7/9—Hazardous Location Disconnect Switch . . . . .	64
Quick Connect Switches . . . . .	66
Solar Disconnect Switch . . . . .	68
Solar Combiner Box—Source Combiner and Array Combiner . . . . .	70
316-Grade Stainless Steel Safety Switches . . . . .	73
Mill-Duty Rated, Heavy-Duty, Fusible, Non-Fusible, Single-Throw . . . . .	77
Heavy-Duty Fusible Safety Switches Accepting Cube Fuses . . . . .	79
Elevator Control Switch . . . . .	82
Auxiliary Power Heavy-Duty Safety Switch . . . . .	84
Left-Handed Safety Switch . . . . .	87
200% Neutral Safety Switches . . . . .	88
Pringle Bolted Pressure Switch . . . . .	89
Type DS, Fusible and Non-Fusible . . . . .	92
Type Visi-Flex DE-ION . . . . .	95
Flange Mounted—Variable Depth . . . . .	99
Flange Mounted—Fixed Depth . . . . .	103
<b>8.2 Enclosed Circuit Breakers</b>	
Product Description . . . . .	105
Application Description . . . . .	105
Features, Benefits and Functions . . . . .	106
Standards and Certifications . . . . .	106
Cross-Reference . . . . .	107
Product Selection . . . . .	109
Accessories . . . . .	111
Flex Center . . . . .	113
Technical Data and Specifications . . . . .	114
Dimensions . . . . .	116
<b>8.3 Enclosed Rotary Disconnects</b>	
Product Overview . . . . .	123
Product Selection . . . . .	124
Dimensions . . . . .	125



*[Faint, illegible text, likely bleed-through from the reverse side of the page.]*

### Contents

Description	Page
Product Overview	
Standards and Certifications . . . . .	5
Cross-Reference . . . . .	6
Catalog Number Selection . . . . .	14
Options and Accessories . . . . .	15
Modifications—Flex Center . . . . .	17
Technical Data and Specifications . . . . .	21
Dimensions . . . . .	21
General Duty . . . . .	24
Heavy-Duty . . . . .	29
Six-Pole Switches . . . . .	42
Double-Throw Switches . . . . .	44
EnviroLine—Stainless Steel Switch . . . . .	52
EnviroLine—Upper and Lower Window Switches . . . . .	55
EnviroLine—Receptacle Switches . . . . .	58
EnviroLine—Non-Metallic Halyster Switch . . . . .	60
EnviroLine—Non-Metallic KRYDON Switch . . . . .	62
NEMA 7/9—Hazardous Location Disconnect Switch . . . . .	64
Quick Connect Switches . . . . .	66
Solar Disconnect Switch . . . . .	68
Solar Combiner Box—Source Combiner and Array Combiner . . . . .	70
316-Grade Stainless Steel Safety Switches . . . . .	73
Mill-Duty Rated, Heavy-Duty, Fusible, Non-Fusible, Single-Throw . . . . .	77
Heavy-Duty Fusible Safety Switches Accepting Cube Fuses . . . . .	79
Elevator Control Switch . . . . .	82
Auxiliary Power Heavy-Duty Safety Switch . . . . .	84
Left-Handed Safety Switch . . . . .	87
200% Neutral Safety Switches . . . . .	88
Pringle Bolted Pressure Switch . . . . .	89
Type DS, Fusible and Non-Fusible . . . . .	92
Type Visi-Flex DE-ION . . . . .	95
Flange Mounted—Variable Depth . . . . .	99
Flange Mounted—Fixed Depth . . . . .	103

### Product Overview

### Product Selection Guide

### Safety Switch

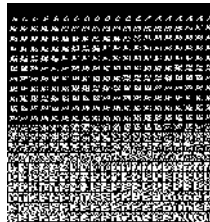

Description	General-Duty	Heavy-Duty	Six-Pole Motor Circuit	Double-Throw	Rotary Switches
Type	Single-throw maximum 240 Vac horsepower rated	Single-throw maximum 600V AC/DC horsepower rated	Single-throw maximum 600 Vac	Maximum 600 Vac horsepower rated	Maximum 600 Vac
Fuse type	Plug	Cartridge	Cartridge	Cartridge	—
Fusible	Cartridge	—	—	—	—
Non-fusible	—	—	—	—	—

### Safety Switch, continued

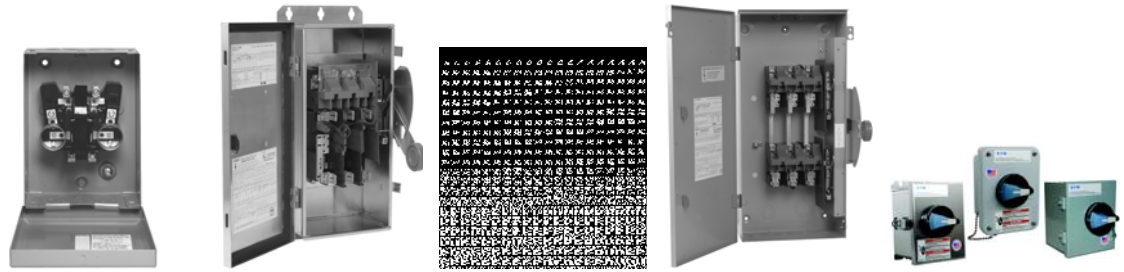

Description	General-Duty	Heavy-Duty	Six-Pole Motor Circuit	Double-Throw	Rotary Switches
Fuse class					
Fusible	—	H	H	H	—
	H	L	H	T (600V) T (240V) T (800V) T (1200V)	—
Non-fusible	—	—	—	—	—
Ampere rating					
Fusible	30 30–600	30–600 30–1200	30–200	30–200 400 600	—
Non-fusible	30–600	30–1200	30–200	30–1200	16–125
Number of poles					
Fusible	1 and 2 2 and 3	2, 3 and 4	6	2 and 3	0
Non-fusible	2 and 3	2, 3 and 4	6	2, 3, 4 and 6	3 and 4
Enclosure types					
NEMA <sup>®</sup> 1					
Fusible	Yes	Yes, up to 1200A	—	Yes	—
Non-fusible	Yes	Yes	—	Yes	Yes
NEMA 3R					
Fusible	Yes	Yes, up to 1200A	Yes	Yes	—
Non-fusible	Yes	Yes	Yes	Yes	Yes
NEMA 12					
Fusible	—	Yes, up to 1200A	Yes	—	—
Non-fusible	—	Yes, up to 1200A	Yes	Yes, up to 400A	Yes
NEMA 4 painted steel					
Fusible	—	Yes, 400–800A	—	—	—
Non-fusible	—	Yes, 400–800A	—	—	—
NEMA 4X stainless steel					
Fusible	—	Yes, up to 1200A	Yes	—	—
Non-fusible	—	Yes, up to 1200A	Yes	Yes, up to 400A	Yes
NEMA 4X non-metallic					
Fusible	—	Yes, up to 200A	—	—	—
Non-fusible	—	Yes, up to 200A	—	—	Yes
NEMA 7/9					
Fusible	—	Yes, up to 200A	—	—	—
Non-fusible	—	Yes, up to 200A	—	—	—

#### Notes

NEMA Type 12 enclosures (30–800A) can be field modified to meet NEMA 3R rainproof requirements when a factory provided drain screw is removed.  
Class J fuse clips provided.

**Product Overview**

- Used to open or close a circuit
- Non-fusible safety switches provide a means to manually connect or disconnect the load from the source
- Fusible safety switches provide a means to manually open and close a circuit and overcurrent protection by means of installed fuses
- Also commonly referred to as a disconnect switch or disconnect
- Available from 30–1200A

**Standards and Certifications**

- UL 98
- UL 50
- NEMA KS-1



# 8.1

## Switching Devices

### Safety Switches

8

#### Double-Throw, continued

Ampere Rating	Catalog Number			
	Eaton	General Electric	Siemens	Square D
<b>Non-Fusible, Four-Pole, Four-Wire, 600 Vac, NEMA 4X</b>				
30	N/A	N/A	N/A	N/A
60	N/A	N/A	N/A	DTU462DS
100	N/A	N/A	N/A	DTU463DS
200	N/A	N/A	N/A	DTU464DS
<b>Fusible, Three-Pole, Three-Wire, 600 Vac, NEMA 4X</b>				
30	DT361FWK	N/A	F351SSDTK	N/A
60	DT362FWK	N/A	F352SSDTK	N/A
100	DT363FWK	N/A	F353SSDTK	N/A
200	DT364FWK	N/A	F354SSDTK	N/A
400	DT365FWK	N/A	F355SSDTK	N/A

#### Catalog Number Selection

##### Safety Switch

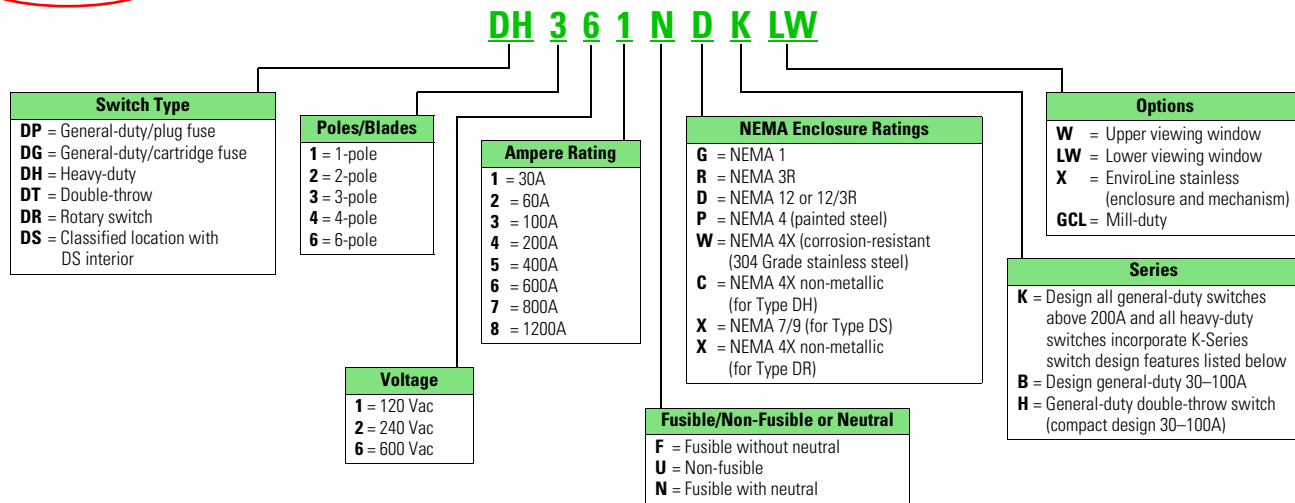

#### Notes

Always verify the number of poles and wires required since catalog numbers may appear in multiple tables.

See **Pages 17** through **20** for additional Flex Center options.

Effective August 2003, 30–100A window switches are replaced by a full view window that allows blade position verification and blown fuse indication. See **Page 37** for catalog numbers.

This table is intended for use in breaking down existing catalog numbers. It is not intended for building new catalog numbers.

Cartridge Fuse General-Duty Safety Switch



### General Duty

#### Product Description

- 30–600A
  - Suitable for service entrance applications unless otherwise noted
  - Fusible and non-fusible switches are 100% load break and 100% load make rated
  - The continuous load current of fusible switches is not to exceed 80% of the rating of fuses employed in other than motor circuits. Non-fusible switches are 100% fully rated
  - 200–600A features K-Series design
  - Horsepower rated
  - Fusible and non-fusible switches. Single-pole S/N through four-wire; 120/240, and 240 Vac
  - With Class R fuses, switches may be used on systems capable of delivering 100,000A rms symmetrical
- Note:** Plug fuse switches are not service entrance rated.
- 120/240 Vac General-Duty, Fusible, Single-Throw**
- 30–600A
  - Suitable for service entrance applications unless otherwise noted
  - Horsepower rated
  - Bolt-on hub provision. Provided for general-duty switches in a NEMA 3R enclosure. See **Page 21** for selection
  - 200–600A switches incorporate K-Series design

### Contents

Description	Page
Product Overview	2
General Duty	24
Features, Benefits and Functions	25
Standards and Certifications	25
Product Selection	26
Technical Data and Specifications	28
Dimensions	28
Heavy-Duty	29
Six-Pole Switches	42
Double-Throw Switches	44
EnviroLine—Stainless Steel Switch	52
EnviroLine—Upper and Lower Window Switches	55
EnviroLine—Receptacle Switches	58
EnviroLine—Non-Metallic Halyester Switch	60
EnviroLine—Non-Metallic KRYDON Switch	62
NEMA 7/9—Hazardous Location Disconnect Switch	64
Quick Connect Switches	66
Solar Disconnect Switch	68
Solar Combiner Box—Source Combiner and Array Combiner	70
316-Grade Stainless Steel Safety Switches	73
Mill-Duty Rated, Heavy-Duty, Fusible, Non-Fusible, Single-Throw Heavy-Duty Fusible Safety Switches Accepting Cube Fuses	79
Elevator Control Switch	82
Auxiliary Power Heavy-Duty Safety Switch	84
Left-Handed Safety Switch	87
200% Neutral Safety Switches	88
Pringle Bolted Pressure Switch	89
Type DS, Fusible and Non-Fusible	92
Type Visi-Flex DE-ION	95
Flange Mounted—Variable Depth	99
Flange Mounted—Fixed Depth	103

#### Non-Fusible Switches

The UL listed short-circuit ratings for Eaton’s non-fusible switches are based on the switches being properly protected by overcurrent protective devices. For applications that require a UL listed short-circuit rating of 10,000A rms symmetrical or less, an Eaton non-fusible switch must be properly protected by any overcurrent protective device rated no greater than the ampere rating of the switch.

For applications that require a UL listed short-circuit rating of greater than 10,000 rms symmetrical amperes, an Eaton non-fusible switch must be properly protected by the appropriate class and size fusing noted on the switch publication (located on the inside cover).

Otherwise, this non-fusible switch must be replaced with an Eaton fusible switch that utilizes the appropriate fusing required. Molded case circuit breaker protection of non-fusible Eaton switches for applications that require a short-circuit rating of greater than 10,000A rms symmetrical has not been evaluated. Refer to the reference tables for typical Eaton fusible switch UL listed short-circuit ratings.

**Note:** Safety switch short-circuit ratings are applicable to AC only. Safety switch I<sup>2</sup>t and I<sub>p</sub> values are identical to UL maximum acceptable I<sup>2</sup>t and I<sub>p</sub> values for the corresponding class fuse.

#### Application Description

For residential and commercial applications. Suitable for light-duty motor circuits and service entrance.

### Features, Benefits and Functions

#### General-Duty (Cartridge Fuse)

- Ample wire bending space provides for easier installation
- Visible double-break quick-make, quick-break rotary blade mechanism
- Side opening door on all enclosures
- Mechanically interlocked cover to prevent easy access when the switch is in the ON position
- With Class R fuses, switches may be used on systems capable of delivering 100,000A rms symmetrical
- Clearly visible and accessible neutral where applicable
- Visible ON/OFF indication
- Tangential knockouts on 30–60A designs
- Ample wiring space
- Double padlocking capability on 30–100A
- Triple padlocking capability on 200–600A
- Additional door locking capability
- Bilingual English/Spanish door label on 30–100A
- Tri-lingual nameplates

All general-duty switches above 100A and all heavy-duty switches incorporate these K-Series switch design features.

- Two points of contact provide a positive open and close, easier operation, and also help prevent contact burning for longer contact life

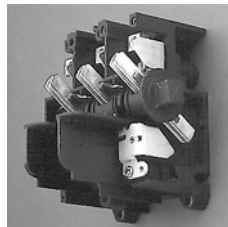

**Visible Double-Break Rotary Blade Mechanism**

- Protects against accidental contact with energized parts. Probe holes enable the user to test if the line side is energized without removing the shield. Not typically provided on general-duty switches, but available as a field kit or factory installed

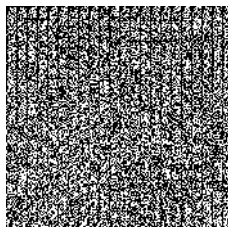

**Clear Line Shield**

- Provide easy removal of fuses

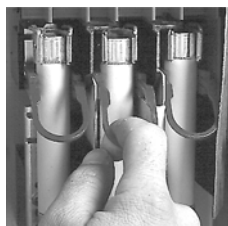

**Built-In Fuse Pullers (NEMA 12 and 4X 30–200A Only)**

- The position (ON or OFF) can be clearly seen from a distance and the length provides for easy operation

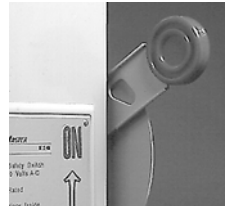

**Clearly Visible Handle**

- Personnel safety feature since the large hasp can accommodate up to three 3/8-inch (9.5 mm) shank locks



**Triple Padlocking Capability**

- Cabinet door can be further padlocked at the top and bottom as applicable

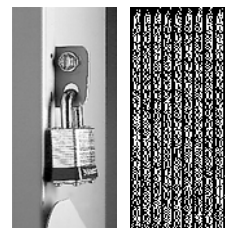

**Additional Locking Capability**

- Door cannot be opened when the handle is in the ON position. Front and side operable defeater mechanism provides for user access when necessary on single-throw switches

**Interlocking Mechanism**

- An ample number are provided on the top, bottom and sides of both NEMA Types 1 and 3R enclosures through 200A

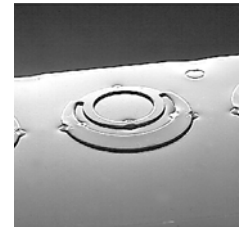

**Tangential Knockouts**

- For switches in a NEMA Type 3R, 30–200A. Use a Myers type hub for all others

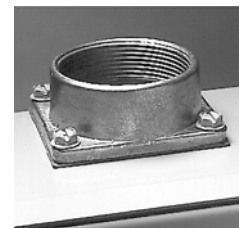

**Bolt-On Hub Kits**

#### Standards and Certifications

- UL listed File No. E5239
- Meets UL 98 for enclosed switches and NEMA Std. KS-1



### DG321NRB

### 120/240 Vac General-Duty, Fusible, Single-Throw, continued



System	Ampere Rating	Fuse Type Provision	Maximum Horsepower Ratings			DC 250V	NEMA 1 Enclosure Indoor Catalog Number	NEMA 3R Enclosure Rainproof Catalog Number
			Single-Phase AC 120V	Single-Phase AC 240V	Three-Phase AC 240V			
<b>Cartridge Type—Three-Pole, Three-Wire (Three Blades, Three Fuses)—240 Vac</b>								
	30	—	—	—	—	—		
	60	—	—	—	—	—		
	100	—	—	—	—	—		
	200	—	—	—	—	—		
	400	H	—	—	50–125	—	DG325FGK	DG325FRK
	600	H	—	—	75–200	—	DG326FGK	DG326FRK
<b>Cartridge Type—Four-Wire (Three Blades, Three Fuses, S/N)—120/240 Vac</b>								
	30	H	—	1-1/2–3	3–7-1/2	—	DG321NGB	DG321NRB
	60	H	—	3–10	7-1/2–15	—	DG322NGB	DG322NRB
	100	H	—	7-1/2–15	15–30	—	DG323NGB	DG323NRB
	200	H	—	15	25–60	—	DG324NGK	DG324NRK
	400	H	—	—	50–125	—	DG325NGK	DG325NRK
	600	H	—	—	75–200	—	DG326NGK	DG326NRK

### DG322URB

### 120/240 Vac General-Duty, Non-Fusible, Single-Throw



System	Ampere Rating	Maximum Horsepower Ratings			DC 250V	NEMA 1 Enclosure Indoor Catalog Number	NEMA 3R Enclosure Rainproof Catalog Number
		Single-Phase AC 120V	Single-Phase AC 240V	Three-Phase AC 240V			
<b>Two-Pole, Two-Wire (Two Blades)—240 Vac</b>							
	30	2	3	—	—	DG221UGB	DG221URB
	60	3	10	—	—	DG222UGB	DG222URB
	100	—	15	—	—	DG223UGB	DG223URB
	200	—	—	—	—		
<b>Three-Pole, Three-Wire (Three Blades)—240 Vac</b>							
	30	2	3	7-1/2	—	DG321UGB	DG321URB
	60	3	10	15	—	DG322UGB	DG322URB
	100	—	15	30	—	DG323UGB	DG323URB
	200	—	15	60	—	DG324UGK	DG324URK
	400	—	—	125	—	DG325UGK	DG325URK
	600	—	—	200	—	DG326UGK	DG326URK

#### Notes

Maximum hp ratings apply only when dual element time delay fuses are used.

Use four-wire catalog numbers below.

Solid neutral bars are not included. Order separately from table on **Page 15**.

**WARNING!** Switch is not approved for service entrance unless a neutral kit is installed.

Use three-wire catalog numbers below.

Drilled to accept field installed neutral kits.

All general-duty safety switches are individually packaged.

Accessories are limited in scope on general-duty safety switches. See **Page 15** for availability. In addition, clear line shields are available as an accessory on 200–600A general-duty switches. Catalog Numbers: 200A = 70-7759-11, 400A = 70-8063-8, 600A = 70-8064-8.



# 8.1

## Switching Devices

### Safety Switches

#### 8

#### Technical Data and Specifications

#### Short-Circuit Ratings Using Class "R", "J" or "T" Fusing Where Applicable

Ampere Rating	Voltage Ratings	
	Type 1	Type 3R
30	100k at 240	100k at 240
60	100k at 240	100k at 240
100	100k at 240	100k at 240
200	100k at 240	100k at 240
400	100k at 250	100k at 250
600	100k at 250	100k at 250

#### Dimensions

Approximate Dimensions in Inches (mm)

#### Plug Fuse, 120, 120/240V, Single-, Two-Pole Solid Neutral, Single-Throw

Ampere Rating	NEMA 1 Height	Width	Depth
30	6.88 (174.8)	4.94 (125.5)	3.44 (87.4)

#### General-Duty, Non-Fusible, 240V, Three-Pole, Single-Throw

Ampere Rating	Width (W)	Height (H)	Depth (D)	Depth (D2)	Weight Lbs (kg)
<b>NEMA 1</b>					
30	6.38 (162.1)	10.69 (271.5)	6.88 (174.8)	3.75 (95.2)	6 (2.724)
60	8.69 (220.7)	14.19 (360.4)	7.38 (187.5)	4.21 (106.9)	9 (4.086)
100	9.13 (231.9)	18.81 (477.8)	7.38 (187.5)	4.23 (107.4)	12 (5.448)
200	16.00 (406.4)	25.25 (641.4)	11.25 (285.8)	6.14 (156.0)	48 (21.792)
400	23.00 (584.2)	44.75 (1136.7)	12.63 (320.8)	7.27 (184.7)	100 (45.4)
600	24.00 (609.6)	52.25 (1327.2)	14.25 (362.0)	8.95 (227.3)	130 (59.02)
<b>NEMA 3R</b>					
30	6.38 (162.1)	10.81 (274.6)	6.88 (174.8)	3.75 (95.2)	6 (2.724)
60	8.69 (220.7)	14.38 (365.3)	7.38 (187.5)	4.21 (106.9)	9 (4.086)
100	9.13 (231.9)	19.25 (489.0)	7.38 (187.5)	4.23 (107.4)	12 (5.448)
200	16.00 (406.4)	25.50 (647.7)	11.25 (285.8)	6.14 (156.0)	55 (24.97)
400	23.00 (584.2)	45.19 (1147.8)	12.63 (320.8)	7.27 (184.7)	105 (47.67)
600	24.00 (609.6)	52.70 (1338.6)	14.25 (362.0)	8.95 (227.3)	135 (61.29)

#### NEMA 1-3R 30-100A General-Duty Non-Fusible and Fusible Single-Throw

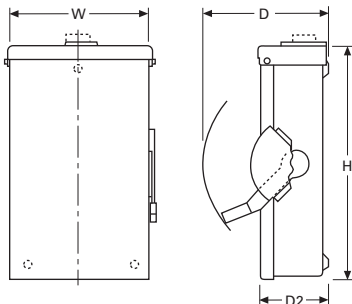

#### General-Duty, Fusible, 240V, Three-Pole Solid Neutral, Single-Throw

Ampere Rating	Width (W)	Height (H)	Depth (D)	Depth (D2)	Weight Lbs (kg)
<b>NEMA 1</b>					
30	6.38 (162.1)	10.69 (271.5)	6.88 (174.8)	3.75 (95.2)	6 (2.724)
60	8.69 (220.7)	14.19 (360.4)	7.38 (187.5)	4.21 (106.9)	10 (4.54)
100	9.13 (231.9)	18.81 (477.8)	7.38 (187.5)	4.23 (107.4)	14 (6.356)
200	16.00 (406.4)	24.75 (628.7)	11.25 (285.8)	6.14 (156.0)	48 (21.792)
400	23.00 (584.2)	44.75 (1136.7)	12.63 (320.8)	7.27 (184.7)	110 (49.94)
600	24.00 (609.6)	52.25 (1327.2)	14.25 (362.0)	8.95 (227.3)	145 (65.83)
<b>NEMA 3R</b>					
30	6.38 (162.1)	10.81 (274.6)	6.88 (174.8)	3.75 (95.2)	6 (2.724)
60	8.69 (220.7)	14.38 (365.3)	7.38 (187.5)	4.21 (106.9)	10 (4.54)
100	9.13 (231.9)	19.25 (489.0)	7.38 (187.5)	4.23 (107.4)	14 (6.356)
200	16.00 (406.4)	25.50 (647.7)	11.25 (285.8)	6.14 (156.0)	55 (24.97)
400	23.00 (584.2)	45.19 (1147.8)	12.63 (320.8)	7.27 (184.7)	115 (52.21)
600	24.00 (609.6)	52.70 (1338.6)	14.25 (362.0)	8.95 (227.3)	150 (68.1)

#### NEMA 1-3R 200-600A General-Duty Non-Fusible and Fusible Single-Throw

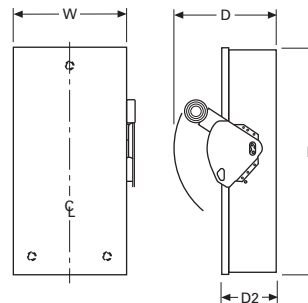

#### Notes

Dimensions are for estimating purposes only.  
Figure is not applicable to plug fuse.

## Heavy-Duty Safety Switch



## Heavy-Duty

## Product Description

- 30–1200A
- 600 Vac, 600 Vdc maximum
- Horsepower rated
- Fusible and non-fusible switches are 100% load break and 100% load make rated
- The continuous load current of fusible switches is not to exceed 80% of the rating of fuses employed in other than motor circuits. Non-fusible switches are 100% fully rated
- Suitable for service entrance applications unless otherwise noted

**240 Vac Heavy-Duty, Fusible, Single-Throw**

- 30–1200A
- Horsepower rated
- Suitable for service entrance use, except four-pole switches
- For factory modifications, refer to **Pages 17** through **20**

**600 Vac Heavy-Duty, Fusible, Single-Throw**

- 30–1200A
- Horsepower rated
- Suitable for service entrance use, except 1200A on 480Y/277 or 600Y/347 grounded wye systems, per NEC 215-10 and 230-95, and four-pole switches
- For factory modifications, refer to **Pages 17** through **20**

## Contents

Description	Page
Product Overview . . . . .	2
General Duty . . . . .	24
Heavy-Duty	
Features, Benefits and Functions . . . . .	30
Standards and Certifications . . . . .	30
Product Selection . . . . .	31
Technical Data and Specifications . . . . .	40
Dimensions . . . . .	41
Six-Pole Switches . . . . .	42
Double-Throw Switches . . . . .	44
EnviroLine—Stainless Steel Switch . . . . .	52
EnviroLine—Upper and Lower Window Switches . . . . .	55
EnviroLine—Receptacle Switches . . . . .	58
EnviroLine—Non-Metallic Halylester Switch . . . . .	60
EnviroLine—Non-Metallic KRYDON Switch . . . . .	62
NEMA 7/9—Hazardous Location Disconnect Switch . . . . .	64
Quick Connect Switches . . . . .	66
Solar Disconnect Switch . . . . .	68
Solar Combiner Box—Source Combiner and Array Combiner . . . . .	70
316-Grade Stainless Steel Safety Switches . . . . .	73
Mill-Duty Rated, Heavy-Duty, Fusible, Non-Fusible, Single-Throw Heavy-Duty Fusible Safety Switches Accepting Cube Fuses . . . . .	79
Elevator Control Switch . . . . .	82
Auxiliary Power Heavy-Duty Safety Switch . . . . .	84
Left-Handed Safety Switch . . . . .	87
200% Neutral Safety Switches . . . . .	88
Pringle Bolted Pressure Switch . . . . .	89
Type DS, Fusible and Non-Fusible . . . . .	92
Type Visi-Flex DE-ION . . . . .	95
Flange Mounted—Variable Depth . . . . .	99
Flange Mounted—Fixed Depth . . . . .	103

## Application Description

For heavy commercial and industrial applications where reliable performance and service continuity are critical.

For the toughest heavy commercial and industrial applications, refer to **Page 77** for catalog information on our mill-duty safety switch

**600 Vac Heavy-Duty, Non-Fusible, Single-Throw**

- 30–1200A
- Horsepower rated
- Suitable for service entrance use, except 1200A on 480Y/277V or 600Y/347V grounded wye systems, per NEC 215-10 and 230-95, and four-pole switches
- For factory modifications, refer to **Pages 17** through **20**

# 8.1

## Switching Devices

### Safety Switches

8

#### Features, Benefits and Functions

- Visible double-break quick-make, quick-break rotary blade mechanism. Two points of contact provide a positive open and close, easier operation, and also help prevent contact burning for longer contact life
- Triple padlocking capability. Personnel safety feature since the large hasp can accommodate up to three 3/8-inch (9.5 mm) shank locks. Cabinet door can be further padlocked at the top and bottom
- Interlocking mechanism. Door cannot be opened when the handle is in the ON position. Built-in defeater mechanism provides for user access when necessary
- Deionizing arc chutes; arc chutes confine and suppress the arcs produced by opening contacts under load
- Mechanically interlocked cover to prevent easy access when the switch is in the ON position
- Clear line shield with probe holes
- Clearly visible palm fitting red handle
- Tangential knockouts on NEMA 1 and NEMA 3R enclosures through 200A
- Built-in fuse pullers on NEMA 4X and NEMA 12 enclosures through 200A
- Additional door locking capability
- Complete accessory and renewal parts data shown on inner door label.
- 30–800A NEMA 12 designs convertible to NEMA 3R by opening factory-installed drain hole
- 30–1200A switches are seismic qualified and exceed the requirements of the Uniform Building Code® (UBC) and California Code Title 24
- Tri-lingual nameplates

All general-duty switches above 100A and all heavy-duty switches incorporate these K-Series switch design features.

- Two points of contact provide a positive open and close, easier operation, and also help prevent contact burning for longer contact life

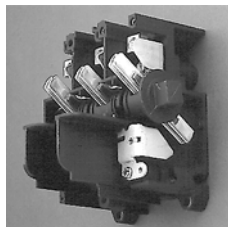

**Visible Double-Break Rotary Blade Mechanism**

- Protects against accidental contact with energized parts. Probe holes enable the user to test if the line side is energized without removing the shield. Not typically provided on general-duty switches, but available as a field kit or factory installed

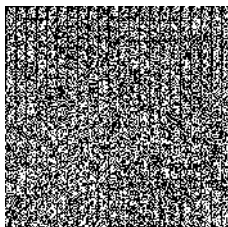

**Clear Line Shield**

- Provide easy removal of fuses



**Built-In Fuse Pullers (NEMA 12 and 4X 30–200A Only)**

- The position (ON or OFF) can be clearly seen from a distance and the length provides for easy operation

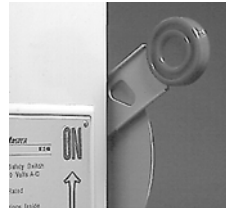

**Clearly Visible Handle**

- Personnel safety feature since the large hasp can accommodate up to three 3/8-inch (9.5 mm) shank locks



**Triple Padlocking Capability**

- Cabinet door can be further padlocked at the top and bottom as applicable

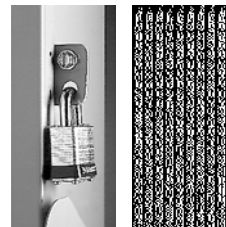

**Additional Locking Capability**

- Door cannot be opened when the handle is in the ON position. Front and side operable defeater mechanism provides for user access when necessary on single-throw switches

**Interlocking Mechanism**

- An ample number are provided on the top, bottom and sides of both NEMA Types 1 and 3R enclosures through 200A

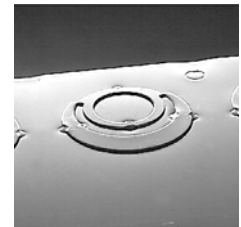

**Tangential Knockouts**

- For switches in a NEMA Type 3R, 30–200A. Use a Myers type hub for all others

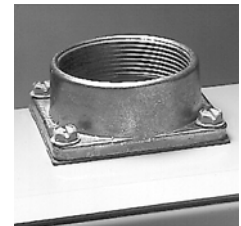

**Bolt-On Hub Kits**

#### Standards and Certifications



- UL listed File No. E5239
- Meets UL 98 for enclosed switches and NEMA Std. KS-1



DH362UGK



### 600 Vac Heavy-Duty, Non-Fusible, Single-Throw, 277/480–600V – NEMA 1, 3R

System	Ampere Rating	Maximum Horsepower Ratings								NEMA 1 Enclosure Indoor Catalog Number	NEMA 3R Enclosure Rainproof Catalog Number
		Single-Phase AC			Three-Phase AC			DC			
		240V	480V	600V	240V	480V	600V	250V	600V		
<b>Two-Pole—480 Vac—600 Vac or Vdc (Suitable for Service Entrance Use with a Neutral Kit Installed)</b>											
	30	3	7-1/2	10	—	—	—	—	15	DH261UGK	DH261URK
	60	10	20	25	—	—	—	—	25	DH262UGK	DH262URK
	100	20	30	40	—	—	—	20	25	DH263UGK	DH263URK
	200	15	50	50	—	—	—	—	50	DH264UGK	DH264URK
	400	—	—	—	—	—	—	50	50	DH265UGK	DH265URK
	600	—	—	—	—	—	—	—	50	DH266UGK	DH266URK
	800	—	—	—	—	—	—	—	—	DH267UGK	DH267URK
	1200	—	—	—	—	—	—	—	—	—	—
<b>Three-Pole—480 Vac—600 Vac, 250 Vdc (Suitable for Service Entrance Use with a Neutral Kit Installed)</b>											
	30	3	7-1/2	10	10	20	30	5	—	DH361UGK	DH361URK
	60	10	20	25	20	50	60	10	—	DH362UGK	DH362URK
	100	20	40	50	40	75	100	20	—	DH363UGK	DH363URK
	200	15	50	50	60	125	150	40	—	DH364UGK	DH364URK
	400	—	—	—	125	250	350	50	—	DH365UGK	DH365URK
	600	—	—	—	200	400	500	—	—	DH366UGK	DH366URK
	800	—	—	—	—	500	500	—	—	DH367UGK	DH367URK
	1200	—	—	—	—	500	500	—	—	DH368UGK	DH368URK
<b>Four-Pole—480 Vac—600 Vac, 250 Vdc</b>											
	30	10	20	25	10	20	30	5	—	DH461UGK	—
	60	20	40	50	20	50	60	10	—	DH462UGK	—
	100	40	50	50	40	75	100	20	—	DH463UGK	—
	200	50	50	50	60	125	150	40	—	DH464UGK	—
	400	50	—	—	125	250	350	50	—	DH465UGK	—
	600	—	—	—	200	400	500	—	—	DH466UGK	—
	800	—	—	—	—	—	—	—	—	—	—

**Notes**

DC rating for 800A switches is 250V.

Contact the Safety Switch Flex Center (1-888-329-9272) for availability of this product.

Ratings are for two-phase AC.

NEMA 12 enclosures (30–1200A) can be field modified to meet NEMA 3R rainproof requirements when a factory provided drain hole is opened.

**Dimensions**

Approximate Dimensions in Inches (mm)

**Note:** Dimensions are for estimating purposes only.

**Heavy-Duty, Non-Fusible, 600V, Three-Pole, Single-Throw**

Ampere Rating	Width (W)	Height (H)	Depth (D)	Depth (D2)	Weight Lbs (kg)
<b>NEMA 1, 3R</b>					
30	8.13 (206.5)	15.88 (403.4)	10.00 (254.0)	5.25 (133.3)	16 (7.264)
60	8.13 (206.5)	15.88 (403.4)	10.00 (254.0)	5.25 (133.3)	16 (7.264)
100	11.13 (282.7)	21.69 (550.9)	10.00 (254.0)	5.25 (133.3)	22 (9.988)
200	16.00 (406.4)	27.63 (701.8)	11.25 (285.8)	6.14 (156.0)	46 (20.884)
400	23.00 (584.2)	45.19 (1147.8)	12.63 (320.8)	7.27 (184.7)	110 (49.94)
600	24.00 (609.6)	52.70 (1338.6)	14.25 (362.0)	8.95 (227.3)	135 (61.29)
800	25.38 (644.7)	56.69 (1439.9)	14.25 (362.0)	8.95 (227.3)	158 (71.732)
1200	41.47 (1053.3)	70.31 (1785.9)	19.94 (506.5)	12.44 (316.0)	430 (195.22)
<b>NEMA 12, 4X Stainless Steel, 4</b>					
30	8.13 (206.5)	12.13 (308.1)	10.00 (254.0)	5.50 (139.7)	17 (7.718)
60	8.13 (206.5)	12.13 (308.1)	10.00 (254.0)	5.50 (139.7)	17 (7.718)
100	11.13 (282.7)	24.00 (609.6)	10.25 (260.4)	5.50 (139.7)	28 (12.712)
200	16.00 (406.4)	34.38 (873.3)	11.50 (292.1)	6.44 (163.6)	55 (24.97)
400	23.00 (584.2)	57.63 (1463.8)	12.63 (320.8)	7.19 (182.6)	125 (56.75)
600	24.00 (609.6)	63.00 (1600.2)	14.25 (362.0)	8.88 (225.6)	167 (75.818)
800	25.38 (644.7)	71.75 (1822.5)	14.25 (362.0)	8.88 (225.6)	175 (79.45)
1200	41.47 (1053.3)	70.31 (1785.9)	19.94 (506.5)	13.51 (343.2)	475 (215.65)

**Heavy-Duty, Fusible, 240V and 600V, Three-Pole Solid Neutral, Single-Throw**

Ampere Rating	Width (W)	Height (H)	Depth (D)	Depth (D2)	Weight Lbs (kg)
<b>NEMA 1, 3R</b>					
30	8.13 (206.5)	15.88 (403.4)	10.00 (254.0)	5.25 (133.3)	20 (9.08)
60	8.13 (206.5)	15.88 (403.4)	10.00 (254.0)	5.25 (133.3)	20 (9.08)
100	11.13 (282.7)	21.69 (550.9)	10.00 (254.0)	5.25 (133.3)	27 (12.258)
200	16.00 (406.4)	27.63 (701.8)	11.25 (285.8)	6.14 (156.0)	52 (23.608)
400	23.00 (584.2)	45.19 (1147.8)	12.63 (320.8)	7.27 (184.7)	120 (54.48)
600	24.00 (609.6)	52.70 (1338.6)	14.25 (362.0)	8.95 (227.3)	153 (69.462)
800	25.38 (644.7)	56.69 (1439.9)	14.25 (362.0)	8.95 (227.3)	168 (76.272)
1200	41.47 (1053.3)	70.31 (1785.9)	19.94 (506.5)	12.44 (316.0)	465 (211.11)
<b>NEMA 12, 4X Stainless Steel, 4</b>					
30	8.13 (206.5)	17.88 (454.2)	10.00 (254.0)	5.50 (139.7)	22 (9.988)
60	8.13 (206.5)	17.88 (454.2)	10.00 (254.0)	5.50 (139.7)	22 (9.988)
100	11.13 (282.7)	24.00 (609.6)	10.25 (260.4)	5.50 (139.7)	30 (13.62)
200	16.00 (406.4)	34.38 (873.3)	11.50 (292.1)	6.44 (163.6)	61 (27.694)
400	23.00 (584.2)	57.63 (1463.8)	12.63 (320.8)	7.19 (182.6)	135 (61.29)
600	24.00 (609.6)	63.00 (1600.2)	14.25 (362.0)	8.88 (225.6)	203 (92.162)
800	25.38 (644.7)	71.75 (1822.5)	14.25 (362.0)	8.88 (225.6)	213 (96.702)
1200	41.47 (1053.3)	70.31 (1785.9)	19.94 (506.5)	13.51 (343.2)	510 (231.54)

**NEMA 1-3R Heavy-Duty 30–1200A**

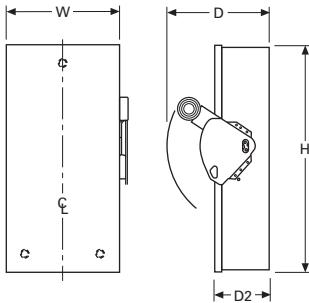

**NEMA 4, 4X and 12 Heavy-Duty 30–1200A**

